

METALMASTER, MUBEA, OMER A & FICEP PUNCHES & DIES

Standard Shapes Add shape code to part number

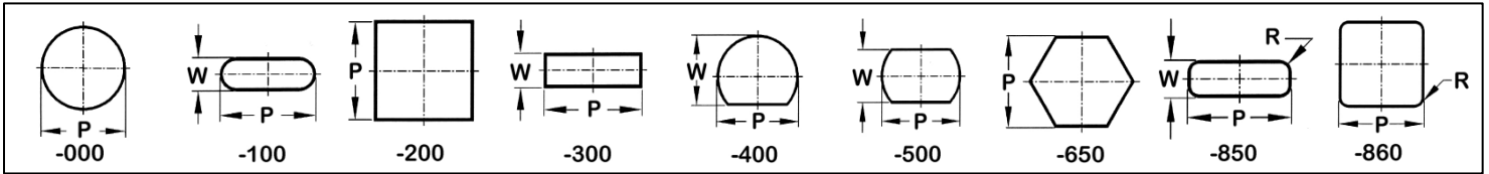

PUNCHES

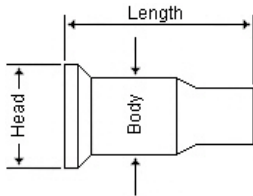

DIES

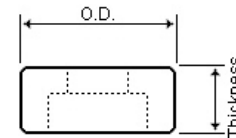

MUBEA METALMASTER

Series	Head	Body	Length	Part No.
#1	20.0	15.0	36.0	SWM1P-xxx
#2	36.0	30.0	66.0	SWM2P-xxx
#3	46.0	40.0	66.0	SWM3P-xxx
#4	56.0	50.0	66.0	SWM4P-xxx

Series	O.D.	Thickness	Part No.
#1	30.0	15.0	SWM1D-xxx
#2	45.0	22.5	SWM2D-xxx
#3	60.0	30.0	SWM3D-xxx
#4	80.0	40.0	SWM4D-xxx

OMERA

Series	Head	Body	Length	Part No.
#0	22.1	18.0	54.0	SWOM0P-xxx
#1	35.0	30.0	57.4	SWOM1P-xxx
#2	35.0	30.0	50.0	SWOM2P-xxx
#5	43.0	35.0	65.0	SWOM5P-xxx

Series	O.D.	Thickness	Part No.
#0	30.0	20.0	SWOM0D-xxx
#3	49.3	22.6	SWOM3D-xxx
#4	45.0	30.0	SWOM4D-xxx
#5	65.0	30.0	SWOM5D-xxx

FICEP

Series	Head	Body	Length	Part No.
#1	16.0	20.0	63.1	SWF1P-xxx
#10	24.8	22.0	49.0	SWF10P-xxx
#13	29.8	26.0	50.0	SWF13P-xxx
#14	31.65	30.0	49.0	SWF14P-xxx
#16	39.6	30.0	68.0	SWF16P-xxx

Series	O.D.	Thickness	Part No.
#1	40.0	19.0	SWF1D-xxx
#10	40.0	22.1	SWF10D-xxx
#13	40.0	30.0	SWF13D-xxx
#14	50.0	30.2	SWF14D-xxx
#16	55.0	30.2	SWF16D-xxx

Recommended die clearance for plate:

Material Thickness	Clearance
Up to 9mm	0.8mm
Over 9mm	1.8mm

Ordering Example:

Obround Punch - 2 x SWOM1P-100 P=10 W=5
 Obround Die - 2 x SWOM1D-100 P=10.8 W=5.8

All specifications, dimensions and design characteristics shown are subject to change without notice.

GLOBAL TOOLS & MACHINES Pty Ltd

Email: sales@globaltools.com.au Mobile: 0409 324 178 Web: www.globaltools.com.au

© The copyright in this material vests in Global Tools & Machines Pty Ltd and may not be reproduced, adapted or communicated without the express written permission of the copyright owner.