

Standard Shapes Add shape code to part number

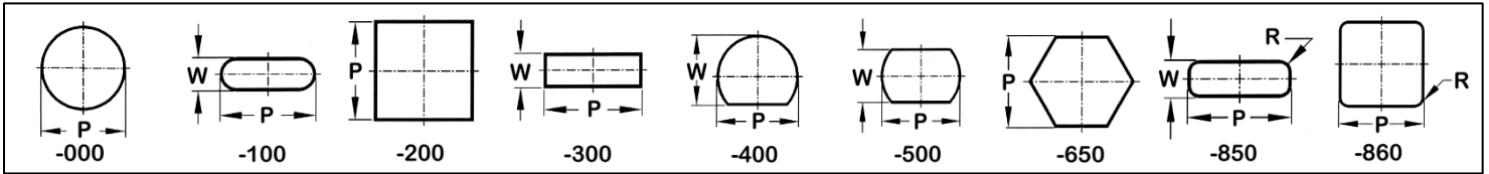

PUNCHES

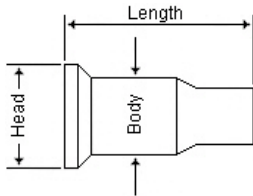

DIES

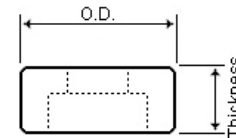

Note: Geka and Mubea punches and dies can be used in most Sunrise machines

GEKA

Series	Head	Body	Length	Part No.
#1	24.0	20.0	39.5	SWG1P-xxx
#2	30.0	26.0	39.5	SWG2P-xxx
#5-15	19.2	15.0	50.0	SWG5-15P-xxx
#5-27	30.5	27.0	50.0	SWG5-27P-xxx
#6	31.5	28.0	58.0	SWG6P-xxx
#8-19	24.0	19.0	62.5	SWG8-19P-xxx
#8-31	35.0	31.0	62.5	SWG8-31P-xxx
#8-40	43.5	40.0	62.5	SWG8-40P-xxx
#10-26	29.5	26.0	71.5	SWG10-26P-xxx
#10-40	43.5	40.0	71.5	SWG10-40P-xxx
#11	54.0	50.0	57.0	SWG11P-xxx
#11A	54.0	50.0	71.5	SWG11AP-xxx
#12	79.0	75.0	57	SWG12P-xxx
#12A	79.0	75.0	71.5	SWG12AP-xxx
#13	104.0	100.0	57.0	SWG13P-xxx
#13A	104.0	100.0	71.5	SWG13AP-xxx

Series	O.D.	Thickness	Part No.
#1	35.0	17.0	SWG1D-xxx
#1A	38.0	22.0	SWG1AD-xxx
#2	43.0	17.0	SWG2D-xxx
#5	50.8	25.5	SWG5D-xxx
#6	46.0	28.5	SWG6D-xxx
#8	60.0	32.0	SWG8D-xxx
#10	73.0	32.0	SWG10D-xxx
#11	78.0	28.5	SWG11D-xxx
#12	100.0	28.5	SWG12D-xxx
#13	125.0	28.5	SWG13D-xxx

MUBEA

Series	Head	Body	Length	Part No.
#1	20.0	15.0	36.0	SWM1P-xxx
#2	36.0	30.0	66.0	SWM2P-xxx
#3	46.0	40.0	66.0	SWM3P-xxx
#4	56.0	50.0	66.0	SWM4P-xxx

Series	O.D.	Thickness	Part No.
#1	30.0	15.0	SWM1D-xxx
#2	45.0	22.5	SWM2D-xxx
#3	60.0	30.0	SWM3D-xxx
#4	80.0	40.0	SWM4D-xxx

All specifications, dimensions and design characteristics shown are subject to change without notice.

GLOBAL TOOLS & MACHINES Pty Ltd

Email: sales@globaltools.com.au

Mobile: 0409 324 178

Web: www.globaltools.com.au

© The copyright in this material vests in Global Tools & Machines Pty Ltd and may not be reproduced, adapted or communicated without the express written permission of the copyright owner.